

■ Not Groomed for Cross-Country Skiing. Great for Snowshoeing.
■ Groomed for Cross-Country Skiing. NOTE: Snowshoers, Please Do Not Step on the Tracks.

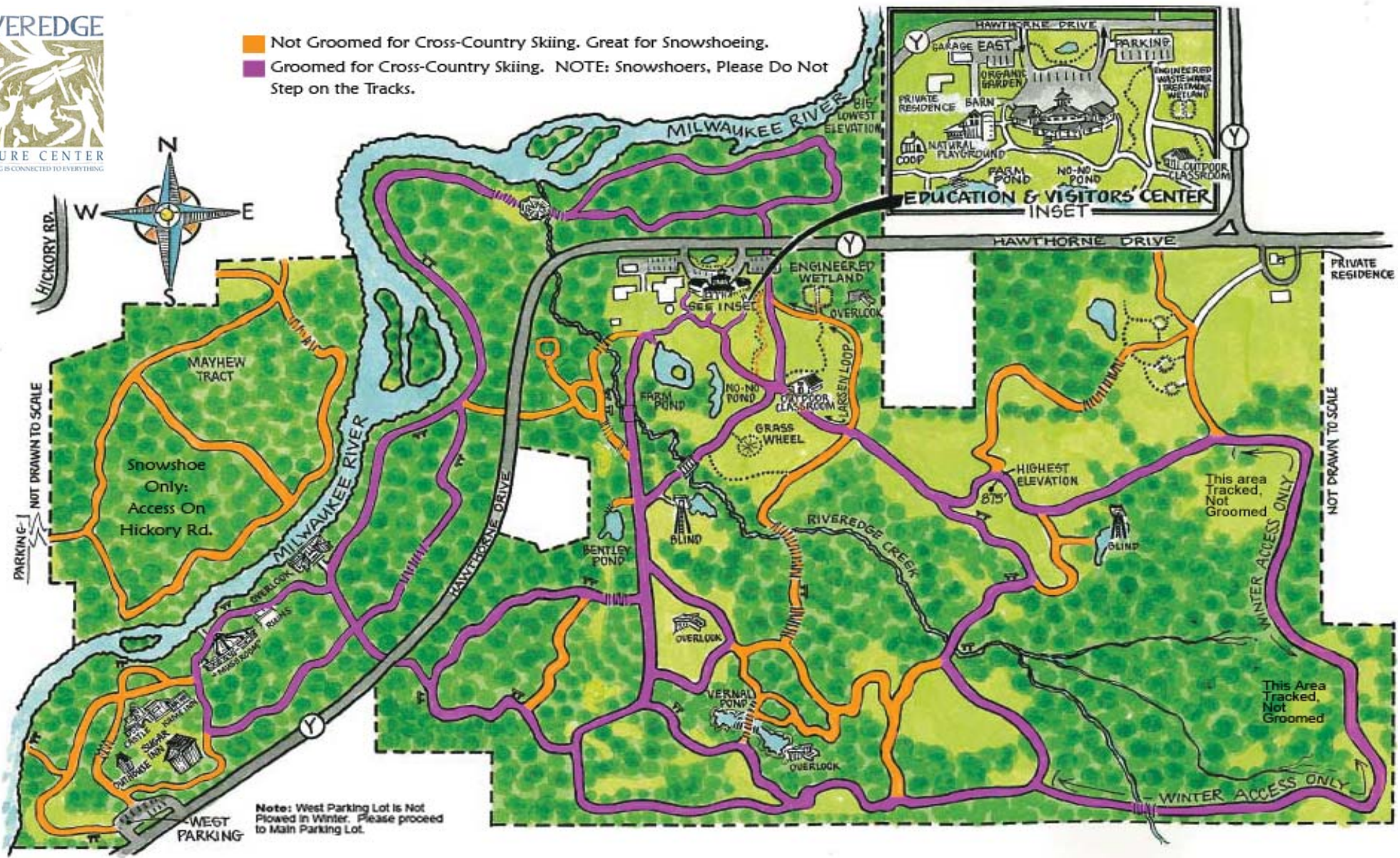

Riveredge Nature Center has over 10 miles of trails, 6 of which are groomed and tracked for cross-country skiing. Please see the reverse side for trail fees and Center information, or visit us online at www.riveredgenaturecenter.org. Ski conditions are available online, or feel free to call 800-287-8098.

When enjoying Riveredge, please remember these few simple rules:

- Hiking & Snowshoeing are permitted on ski trails but not on top of the ski tracks.
- Non-members pay a nominal trail fee which supports trail maintenance.
- No dogs or other pets are allowed, other than guide dogs.
- Specially designated snowshoe trails are also located on RNC property across the river (Access and parking on Hickory Road).
- Refrain from smoking when in buildings and on grounds.
- Riveredge is not responsible for skiers or hikers who attempt to cross the Milwaukee River.

Events

Holiday Snowshoe Hike: Family Program

Friday, December 27, 1-3pm

Bring the whole family to explore Riveredge's winter wonderland. The hike will either be on foot or snowshoes, depending on snow depth. Snowshoe supply is limited so register early. Children under 12 must be accompanied by an adult.

Pre-registration is recommended.

Fee: \$5 per person for Trail Pass Members and Non-Members

All Access Members: Free

Adult & Family Night Ski and Snowshoe

Friday, January 3, 10, 17, 24, 31 and February 7 & 14, 4-8pm

Enjoy the beauty and serenity of a crisp snowy evening on skis or snowshoes. Traverse our 1½ mile trail, lighted by the soft glow of lanterns, or ski those trails lit only by the light of the moon and stars. Refreshments await you at the end of the trail. Call or check our website for current snow conditions before venturing out.

Fee: \$5 per person for Non-Members

Trail Pass and All Access Members: Free

Riveredge Silent Sports: New Year Snowshoe (or Run/Hike)

Adults and Children 12 & Up

Saturday, January 4, 1-2pm

Resolve to get fit and enjoy the beauty of winter in Wisconsin – snowshoes make it possible! Join a Riveredge naturalist for a workout adventure on breathtakingly beautiful forest, prairie, and riverside trails. Whatever your pace, come for the camaraderie, the winter beauty, and the best workout nature has to offer.

Fee for participants borrowing snowshoes from Riveredge:

Non-Member: \$10/Trail Pass Member: \$5/All Access Member: FREE

Fee for those bringing their own snowshoes (or if we hike/run instead of snowshoe:

Non-Member: \$5 / Trail Pass & All Access Member: Free

Ski 101: Adult Program

Saturday, January 20, 1- 2:30pm

Bring your cross-country skis to Riveredge and learn basic cross-country skiing techniques and safety tips. Beginner skiers will practice gliding, turning and even falling! Register early- space is limited (Snow-dependent).

Fee: \$5 per person for Trail Pass Members and Non-Members

All Access Members: Free

Winter Snowshoe Night Hike: Family Program

Saturday, January 18, 7-8:30pm

Imagine snowshoeing under the clear, crisp winter night sky with the moonlight reflecting off the snow. Enjoy the beauty of a nighttime snowshoe hike. Discover the creatures active after dark and explore the night sky. All ages will enjoy this adventure. Riveredge will provide the snowshoes (or use your own). Dress for the weather and wear insulated boots. If there is not enough snow for snowshoeing, we will still hike. Hot drinks will be served afterward. Space is limited; please call to reserve your spot.

Fee: Adult \$7, 12 & under \$5

Trail Pass and All-Access Members: Adult \$5, 12 & under \$4

Information

Snowshoe or Cross-Country Ski Trail Fees:

Members: Free

Adults: \$4

Children ages 4-12: \$2

Children 3 & Under: Free

Family: \$12

All non-member trail users (hikers, skiers and snowshoers) should purchase a trail pass at the visitor center or by using our pay envelopes located at the front door of the visitor center and at trailheads. The passes can be returned within one week for a rebate of up to \$12 on the \$40 membership price. To become a member, stop in at the visitor center or use the online forms at www.riveredgenaturecenter.org.



Snowshoes Available for Rent:

We have a limited number of snowshoes, so all rentals are on a first come, first serve basis. Snowshoes must stay on Riveredge property. Reservations made in advance must include a credit card number. You will be charged for the rental unless we receive your cancellation within 24 hours. Snowshoes must be returned by 4:45pm on weekdays and 3:45pm on Saturdays and Sundays. All snowshoes not returned on time will be charged a replacement fee. Please visit our website or call for more details.

Fees: \$10 per hour/person **trail fee included

Trail Pass Members: \$5 per hour/person

All Access Members: Free



Riveredge Visitor Center Hours are as follows:

Weekdays 8am - 5pm

Saturday 9am - 4pm

Sunday Noon - 4pm

Phone: (262) 375-2715 / (800) 287-8098

Trails are open daily from dawn to dusk.



4458 County Hwy Y, Saukville, WI 53080

Ski & Snowshoe Trails



RIVEREDGE NATURE CENTER

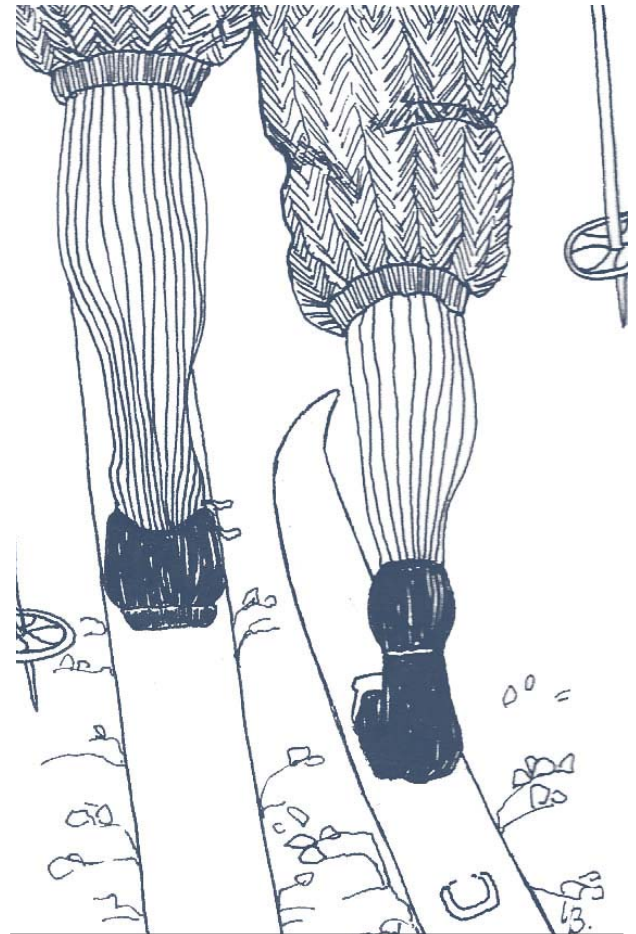

Riveredge Nature Center

4458 County Hwy Y

Saukville, WI 53080

www.riveredgenaturecenter.org